

Kubika



Solution d'équipement pour pare douche
Glass shower equipment solution





Nouvelles formes ...

New shapes ...



Étanchéité totale

Full seal

Cette charnière à mécanisme déporté, permet l'installation d'un joint sur toute la hauteur de la porte sans interruption et contribue ainsi à optimiser l'étanchéité de l'ensemble.

The hinge with an offset mechanism means that a sealing strip can be assembled on the whole length of the door without interruption and this optimises water tightness.

Poids maximum de la porte = 45kg

Maximum weight of the door = 45kg

Ajustement de l'angle

Angular blocking system

Brevet exclusif Stremler, le système de réglage largement éprouvé sur l'ensemble de notre gamme de charnières, permet de régler facilement l'angle de la porte après la pose.

Exclusive Stremler's patent, the system of adjustment which has been tried and successfully tested on our ranges of hinge, makes the positioning of the door closed easy when assembling.

Pour verre de 8 et 10 mm

For 8 and 10mm thick glass.



... nouveaux avantages

... new advantages

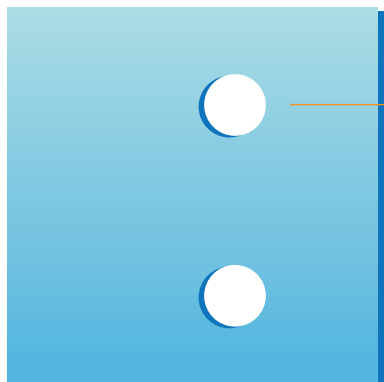

Encoche simple

Simple notch

Encoche 2 trous $\varnothing 16$ mm
2 holes $\varnothing 16$ mm

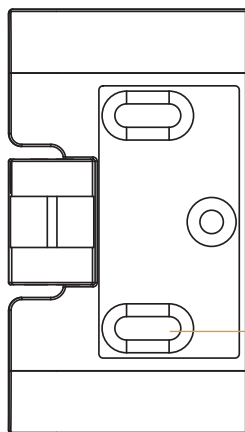

**Positionnement facile
de la charnière**

Easy hinge positioning

L'équerre est équipée de trous oblongs permettant d'ajuster facilement la position de la charnière lors de la pose.

Un cache rend invisible les vis de fixation pour un meilleur esthétisme.

The fixing square has oblong holes to enable easy positioning of the hinge.

An adhesive cover hides the screws for a better looking shower.





Une gamme complète

Full range



Charnière simple

Single hinge

Chromé brillant 3460.30.ORNS
Bright Chromium

Chromé mat 3460.31.ORNS
Matt Chromium

Effet Inox 3460.35.ORNS
Stainless steel effect



Bouton

Knob

Chromé brillant 3466.30.O
Bright Chromium

Chromé mat 3466.31.O
Matt Chromium



Charnière double

Double hinge

Chromé brillant 3462.30.ORNS
Bright Chromium

Chromé mat 3462.31.ORNS
Matt Chromium

Effet Inox 3462.35.ORNS
Effet Inox



Barre raidisseur

Reinforcement bar

Mur / Verre 1657.30.OSQ
Wall / glass

Verre / Verre 1658.30.OSQ
Glass / glass

Angle Mur / Verre 1652.30.OSQ
Corner wall / glass



Pièce de fixation

Partition clip for fixed panel

Chromé brillant 3265.30.OSQ
Bright Chromium

Chromé mat 3265.31.OSQ
Matt Chromium

Effet Inox 3265.35.OSQ
Stainless steel effect



Joint Masse réduite

Super slim seal

Verre 8 mm

8mm glass
1806.66.3 MR



Verre 10 mm

10mm glass
1806.66.4 MR



Une solution pour toutes les configurations

A solution for all the configurations





Dans le détail

In detail

Charnière simple 3460.XX.ORNS

Simple hinge

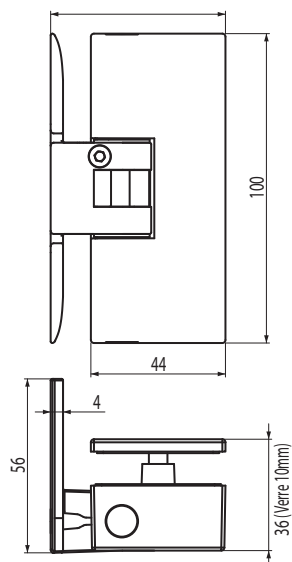

Charnière double 3462.XX.ORNS

Double hinge

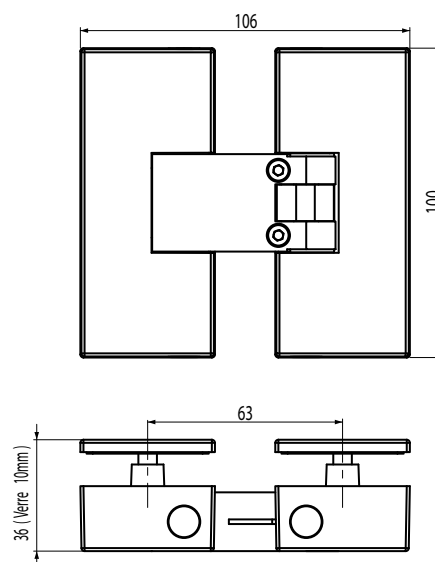

Encoche simple pour 3460 et 3462

Simple notch for 3460 and 3462

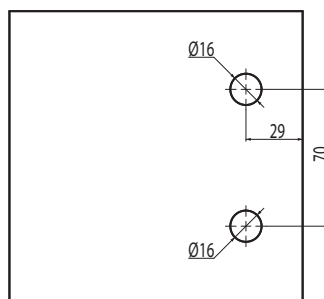



Dans le détail

In detail

Barre raidisseur 165X.XX.05Q
Reinforcement bar

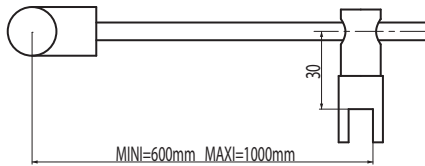
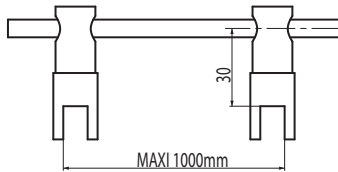
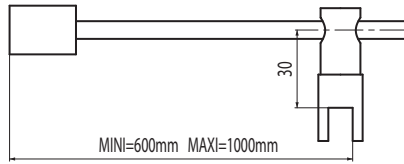

Bouton 3466.XX.0
Knob

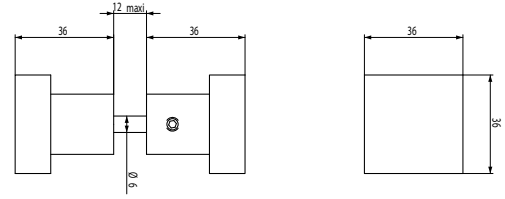

Pièce de fixation 3265.XX.05Q
Partition clip for fixed panel

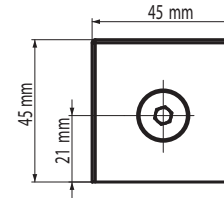

Joint 1806.66.3MR
Sealing strip



Joint 1806.66.4MR
Sealing strip

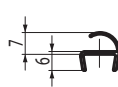

Encoche M302 pour pièce de fixation 3265
Partition clip notch

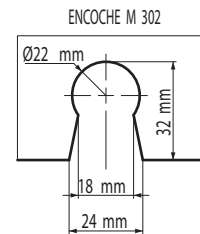

Kubika



www.stremler.fr



ASSA ABLOY CÔTE PICARDE S.A.S
Rue Alexandre Fichet
80460 Oust Marest

Tél. : 03 22 23 76 00
Fax : 03 22 23 28 01
accueil@stremler.fr

Votre distributeur / Your dealer

www.v3s-glass-systems.be

ASSA ABLOY is the global leader in door opening solutions, dedicated to satisfying end-user needs for security, safety and convenience.